



PROJECT GUIDE

HOW TO INSTALL LOCKING VINYL PLANK



When it comes to installing flooring products, it doesn't get much simpler than locking vinyl plank, as this easy-to-follow guide will show you.

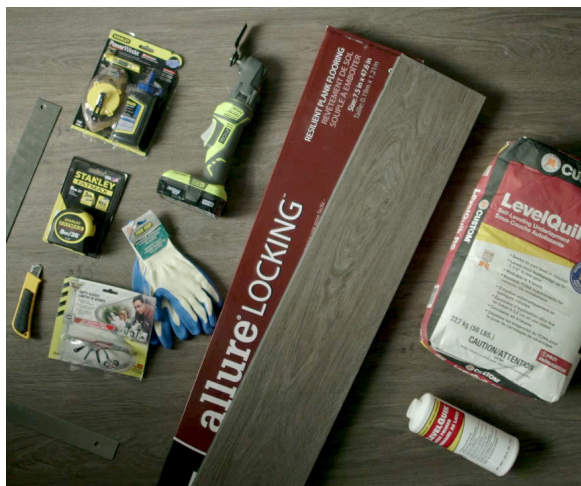

TOOLS

- Tape measure
- Heavy duty cutter
- Work gloves
- Utility Knife
- Straight Edge
- 1/4" Spacers

MATERIALS

- Self-levelling underlayment
- Latex primer
- Allure Locking Plank
- Vinyl flooring



PROJECT GUIDE

HOW TO INSTALL LOCKING VINYL PLANK

STEP 1

ACCLIMATE PLANKS



Begin by **laying out your unopened boxes of planks** in the room where they will be installed at least two days before you start, so they can acclimate to the temperature and humidity.

NOTE: Allure Locking Vinyl Plank is for interior installations and only in temperature controlled environments. Allure Locking Vinyl Plank should not be installed in an environment where the temperature is allowed to go below 18°C or above 30°C."

STEP 2

PREP SUBFLOOR



One of the great things about locking vinyl plank is that it can be installed over most existing floors with minimal preparation, but you'll still want to **ensure the subfloor surface is smooth, flat, dry, clean and solid.**



Remove any carpet staples or adhesive residue, check for moisture, fill any large holes and ensure screws are countersunk.



Then sand down any uneven spots over 5 millimeters. If you are replacing any previously installed vinyl flooring, never begin sanding it before consulting a professional beforehand.



PROJECT GUIDE

HOW TO INSTALL LOCKING VINYL PLANK

STEP 3

PLAN FLOORING LAYOUT



Before you start, you'll need to determine how the entire floor will lay out in order to ensure the planks on either side of the room are similar in size. Begin by **measuring the length of the room and divide by the length (long side) of the Allure plank you are installing**. If the number is less than 12" you need to cut your first plank accordingly to avoid planks less than 12" on the opposite side of the room.

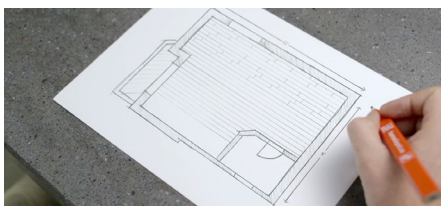

Also **measure the width of the room**. Divide the width of the room by the width of the Allure plank (short side). If the number is less than half the width of the plank, then your first row needs to be cut length-wise on both the first and last rows (they should be the same width on the first and last rows). Avoid having a row of less than half the width of the plank being installed.

STEP 4

CUT FIRST AND/OR LAST PLANKS TO LENGTH



Starting in a corner, **lay out a row of loose planks** without securing them to each other to determine if you need to adjust the length of the first plank to avoid a small piece of less than 12" on the opposite wall from where you started. The last plank should be the same length as the first one.





PROJECT GUIDE

HOW TO INSTALL LOCKING VINYL PLANK

STEP 5

SCORE AND SNAP TO CUT



To cut a plank simply **measure and mark the plank**, then using your straight edge and utility knife, score the plank and snap.



STEP 6

BEGIN INSTALLING ROWS



Starting from a corner, **install the first row and proceed from the wall with the tongue facing the wall**, allowing a gap of 1/4" for expansion, which should be covered by moulding. When laying the first row interlock the short ends by inserting the tongue into the groove at an angle of 10° to 20°. Install each sequential plank on the short end and be sure to line up evenly. This step is very important for a good installation.

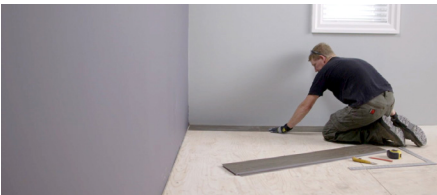



PROJECT GUIDE

HOW TO INSTALL LOCKING VINYL PLANK

STEP 7

KEEP SEAMS BONDED AND TIGHT



Be sure to keep the seams tight. There should be no gap visible between the planks. If your seam is not tight, slowly and gently lift the top plank edge away from the bottom plank edge and reapply. Pulling the planks apart too quickly could rip or damage the locking edges.



STEP 8

START SECOND ROW

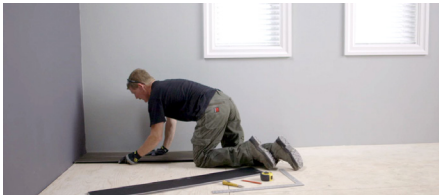

Start the second row with a **plank cut at about 2/3 length**. To cut a plank, simply measure, mark, score and snap. Interlock the plank tightly against the first row (long side) again at a 10-20 degree angle. For the next plank, interlock the short side first, leaving it slightly away from the long side and then slide into the long side.





PROJECT GUIDE

HOW TO INSTALL LOCKING VINYL PLANK

STEP 9

START THIRD ROW



Start the third row with the **plank cut at 1/3 of a length (16")**. The remaining piece can be used at the opposite end of the row, if the layout of the room permits.

You'll also want to stagger the seams or end joints at least 6" apart for a more natural looking appearance.

STEP 10

HOW TO FIT AROUND IRREGULAR OBJECTS

For irregular objects such as pipes, **make a pattern out of heavy paper to fit around the object**. Place the pattern on the plank and trace. Cut along trace lines using a utility knife or heavy duty scissors, and lay a plank. Be sure to leave 1/4" of expansion space around all fixed objects, floor vents and door frames.

STEP 11

INSTALL THRESHOLDS AND MOULDING



Once all the flooring has been completed, finish up by **installing matching thresholds and quarter-round moulding** to the walls using finishing nails.



GET STARTED AND VISIT THE HOME DEPOT TODAY

Visit homedepot.ca for more great projects.